



Azure Dynamics Balance™ Hybrid Electric Vehicle Operation

Starting Vehicle

This is a Hybrid Electric Vehicle and it can be driven in the same manner as a conventional vehicle.

Turn the key to the “Crank” position and hold the key in the “Crank” position for 1 second and then release. The engine may or may not start this is normal. Look for the **Green “Hybrid Enabled” light** to illuminate. Once this **Green light** is on steady, **the vehicle is ready to drive, even if the engine is off.**

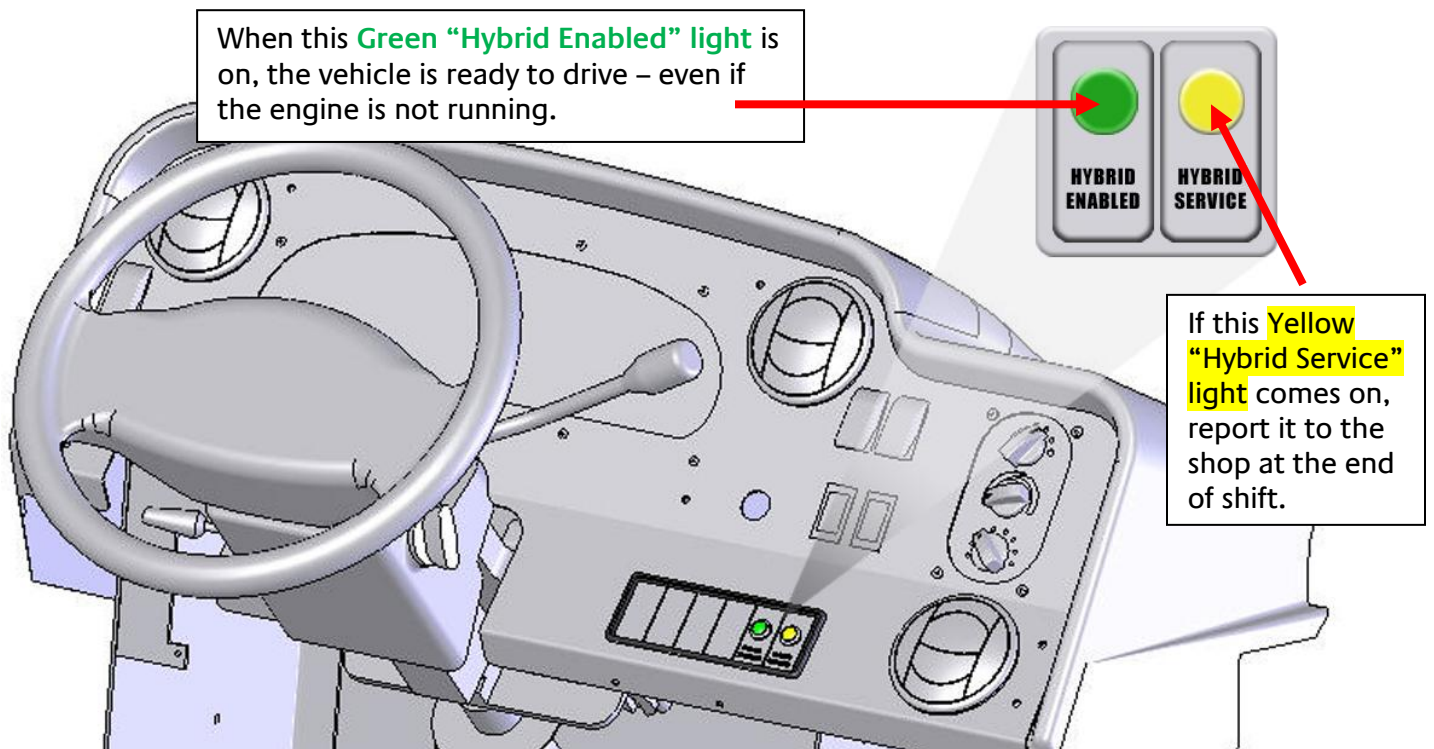

Light location may vary depending on application

Notes

It is normal for the engine to shut off when the vehicle comes to a stop and the vehicle is still drivable while the engine is off. The engine will be commanded on only when necessary.

12 Volt Battery/Boosting

The 12 volt battery is the same as the one used in a non-hybrid vehicle. It is located in its original location under the hood of the vehicle. It is used to supply power to all of the same components in a non-hybridized vehicle, as well as the high voltage control circuits. This battery can be boosted and charged as it would be in a non-hybrid vehicle.

Troubleshooting

Vehicle fails to start – i.e.: Green Hybrid enable light is off

- > Low 12 Volt battery voltage is the #1 cause of a no start condition. Attempt to boost the 12 volt battery and restart the vehicle.
- > Cycling the ignition key too quickly can cause a temporary no start condition. Turn the key to the off position, wait 5 seconds then attempt to restart.
- > Ensure the shifter is fully seated in the “Park” Position.

Vehicle overheating

- > Check oil and coolant levels.

Noise

- > The hybrid vehicle has some unique electric motor noises when the engine starts and during vehicle deceleration. This is normal.

For all other concerns, please contact Azure Dynamics directly. Please refer to the contact info below.

Contact Information

Azure Dynamics Inc.

Product Support / Techline Support

Toll Free Number: 1.866.473.1636

Phone: 905.607.3486

Email: productsupport@azuredynamics.com

Email: techline@azuredynamics.com